



Top 2000 TBi 8W

Water cooling

Designed for use with thick wires

Technical data

MIG/MAG (GMAW) Semi-automatic welding torch TBi 8W

Rating at 100% duty cycle
(10 min. cycle)

- Mixed gas: 500 A
- CO₂: 550 A

Cooling method Water cooling

Wire diameter 1.2 - 3.2 mm

Gas flow 28 l/min

Technical specification according to IEC 60974-7

Weight with 1.5m cable 1.70 kg

Connection Euro-Central connector
Other connectors (e.g. CLOOS®, ESAB®, Lincoln®) available upon request.

Torch rating will be reduced when using pulsed-arc power sources. Special torch necks and custom lengths of the cable assembly are available upon request.

Ordering Information

TBi 8W RWZ, 40° bent 172P5425_0*

* At the blank, please insert 3, 4 or 5 for a torch length of 3, 4 or 5 m.

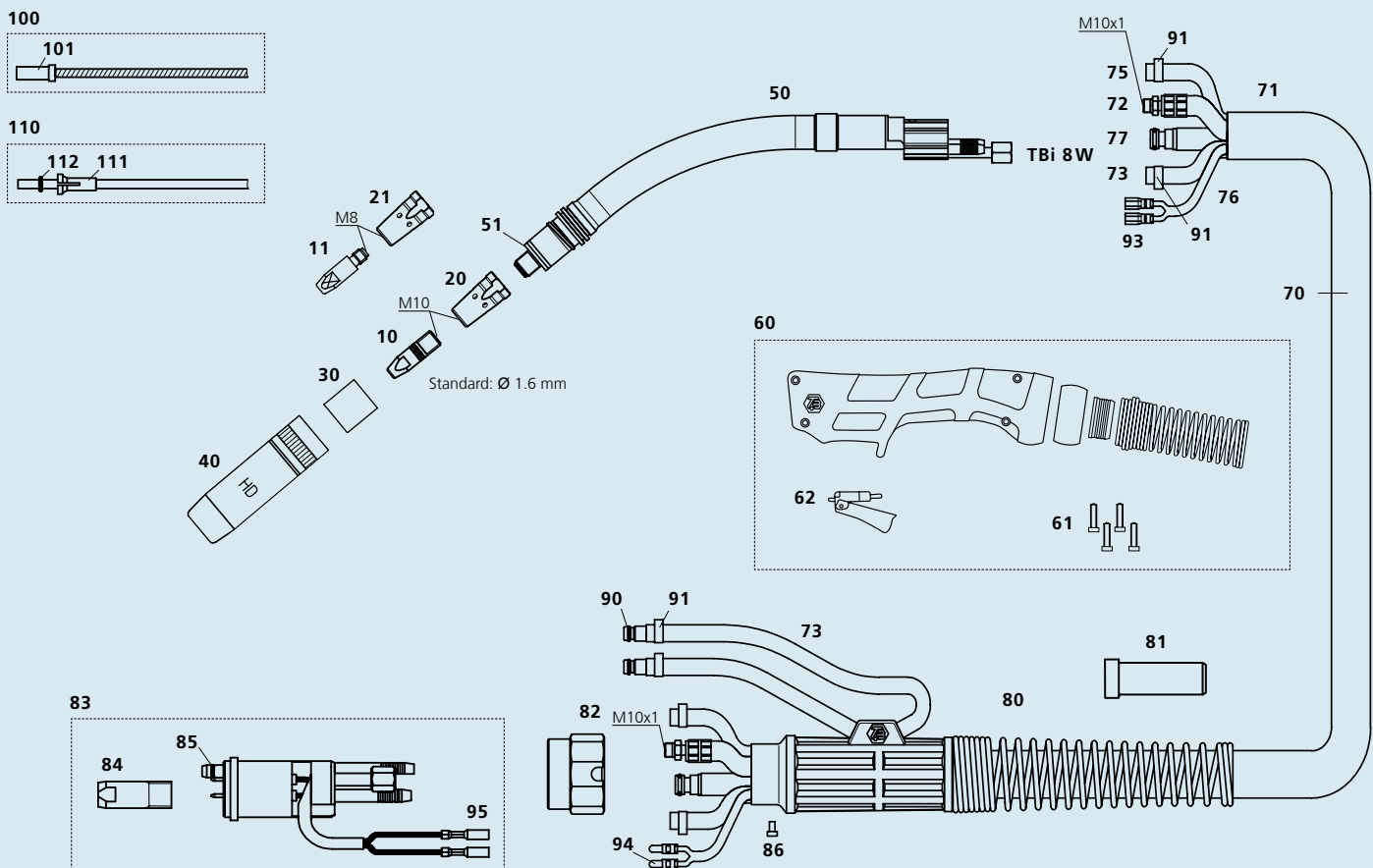

Pos.	Description	Part. No.	Pos.	Description	Part. No.
Contact tips					
▶ 10	Contact tip M10x33, Ecu	340P_1402*	81	Cable support 70 sqmm	600P002107
10	Contact tip M10x33, CuCrZr	343P_3402*	82	Adaptor nut	701P001013
11	Contact tip M8x30, Ecu	340P_1262*	83	Central adapter RWZ cpl. (8W, 10W), moveable pins	701P001001
11	Contact tip M8x30, CuCrZr	340P_3262*	84	Centering bolt M14x1 RGZ / RWZ	701P002083
11	Contact tip M8x30 Alu, Ecu	341P_1262*	85	O-ring 4.0x1.0 mm (gas nipple)	365P100040
Tip holders					
▶ 20	Tip holder M10 / L=29 mm	342P010072	86	Slotted screw M4x6	100P008401
21	Tip holder M8 / L=30 mm	342P008072	90	Quick connector	701P002064
Nozzle insulators					
▶ 30	Nozzle insulator glasfiber	346P054860	91	Hose clamp Ø 9.5 with ring	373P100095
Gas nozzles					
▶ 40	Nozzle con. diam. 16.0mm L=80.5mm, HD	345P922271	93	Cable lug, flat	375P000023
Spare parts					
50	Torch neck TBi 8W, 40°	172P101001	94	Insulated connector, male, round	375P000004
51	Insulating washer	130P002003	95	Insulated connector, female, round	375P000003
60	Handle blue, cpl. kit TBi 8W	380P220404	Wire guides		
61	Cross recessed screw M3.5x14	100P008413	100	Liner w/o insulation (x.40 m) for wire 1.6-2.0	322P2863_4*
62	Trigger, red, 2 poles	385P021016	▶ 100	Liner w/o insulation (x.40 m) for wire 1.6-2.4	322P3570_4*
70	Cable assembly TBi 8W	172P4S45_0*	100	Liner w/o insulation (x.40 m) for wire 2.4-3.2	322P4570_4*
71	Fabric outer cover 25x1.5 mm, cpl.	307P2528_A*	110	PTFE liner white (x.50 m) for wire 1.6-2.8	326P4060_5*
72	Water-power cable HD (TBi 8W, 10W)	314P16GG_0*	111	Collet for teflon and PA liners 4.0x6.0	331P040060
73	Water hose 2-C, black, 5x1.5 mm	303P070000	112	O-ring 5.0x1.5 mm	365P150050
75	PVC-Gas hose, black, 5x1.5 mm	302P020000			
76	Control cable x.30 m cpl.	301P2304_0*			
77	Wire conduit, black (TBi 8W, 10W)	354P0C0C_0*			
80	Cable support 3 parts cpl. with spring	701P101071			

▶ = Standard equipment

* At the blank, please insert suitable information for torch length or wire diameter, e.g. 08 for 0.8 mm or 3 for 3 mm.

© 2010 TBI Industries GmbH. All rights reserved. Subject to change without notice. Warranty only when using original TBI consumables and spare parts. Excerpts and reprints not permitted.
Nr. DOKP112172, 06/2010.

TBI Industries GmbH
Ruhberg 14
D-35463 Fernwald-Steinbach
P.O. Box 67
D-35461 Fernwald-Steinbach

Tel. + 49 6404 9171-0
Fax. + 49 6404 9171-40
Internet: www.tbi-industries.com
E-mail: info@tbi-industries.com