



TBi X-Power MIG/MAG Welding torches

Versatile and powerful

Ease of maintenance

Neck can be exchanged quickly

Rating

TBi XP 363-L DR Gas cooled	60% (10 min.) Mix: 310 A CO ₂ : 340 A
--------------------------------------	--

TBi XP 363-S DR Gas cooled	60% (10 min.) Mix: 310 A CO ₂ : 340 A
--------------------------------------	--

TBi XP 463-L DR Gas cooled	60% (10 min.) Mix: 350 A CO ₂ : 380 A
--------------------------------------	--

TBi XP 463-S DR Gas cooled	60% (10 min.) Mix: 320 A CO ₂ : 340 A
--------------------------------------	--

Torch rating will be reduced when using pulsed-arc power sources.

Technical Data

Cooling method	Gas cooling
Wire diameter	1.0 - 1.6 mm
Gas flow	16 l/min
Technical specification	according to IEC 60974-7
Connection	Euro-Central connector Other connectors are available upon request.



Quick change of neck

The XP torch neck can be turned and fixed at any angle to adjust to different welding tasks. When repairing the torch, the neck can be replaced within seconds without opening the handle.

When the locking screw is tightened, the neck is firmly held in position.

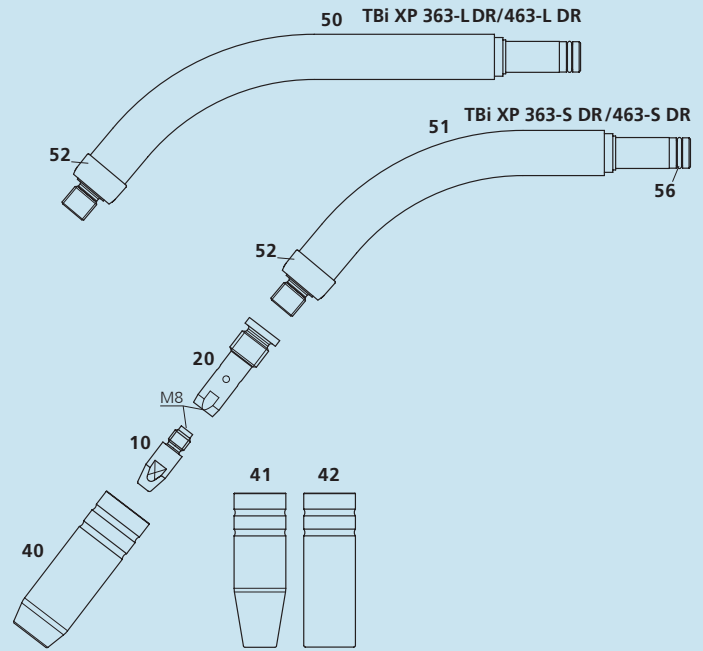

Ordering information for torches

Supplied equipped for steel wire Ø 1.2 mm

▶ TBi XP 363-S DR	with Euro central connector	3 m	145P329030
		4 m	145P329040
		5 m	145P329050
TBi XP 363-S DR	with Euro central connector and long trigger	3 m	145P3L9030
		4 m	145P3L9040
		5 m	145P3L9050
TBi XP 363-L DR	with Euro central connector	3 m	145P32A030
		4 m	145P32A040
		5 m	145P32A050
TBi XP 363-L DR	with Euro central connector and long trigger	3 m	145P3LA030
		4 m	145P3LA040
		5 m	145P3LA050
▶ TBi XP 463-L DR	with Euro central connector	3 m	145P322030
		4 m	145P322040
		5 m	145P322050
TBi XP 463-L DR	with Euro central connector and long trigger	3 m	145P3L2030
		4 m	145P3L2040
		5 m	145P3L2050
TBi XP 463-S DR	with Euro central connector	3 m	145P321030
		4 m	145P321040
		5 m	145P321050
TBi XP 463-S DR	with Euro central connector and long trigger	3 m	145P3L1030
		4 m	145P3L1040
		5 m	145P3L1050

Contact tips

	Pos.	Part no.
M8 	▶ 10 ECu, M8 x 30	340P__1262*
	CuCrZr, M8x30	340P__3262*
	Alu, ECu, M8x30	341P__1262*

▶ = Standard equipment

* At the blank, please insert suitable information for wire diameter, e.g. 08 for 0.8 mm.

Spare parts

Pos.	Description	Part no.
50	Torch neck TBi XP 363-L DR/463-L DR, 50°	145P101002
51	Torch neck TBi XP 363-S DR/463-S DR, 45°	145P101001
52	Insulating	145P102004
53	Clamping block, TBi XP	145P102003
54	Screw for clamping block	109P798409
55	Grommet	145P102007
56	O-Ring 8.0 x 1.5 mm	365P150080
60	Handle Expert for TBi XP, cpl.	380P230005
61	Handle Expert for TBi XP, cpl., long trigger	380P230006
62	Screw for Expert handle	100P541101
63	Trigger, red, 2 poles	385P021016
64	Trigger, red, 2 poles, long	385P021018

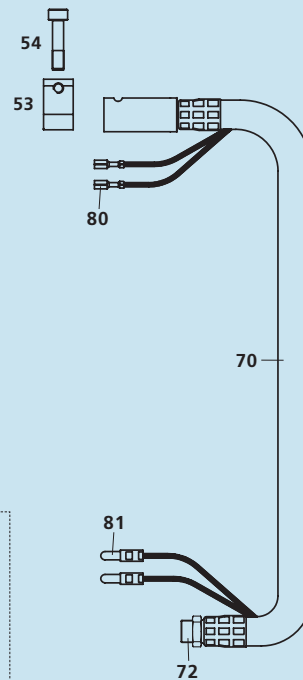
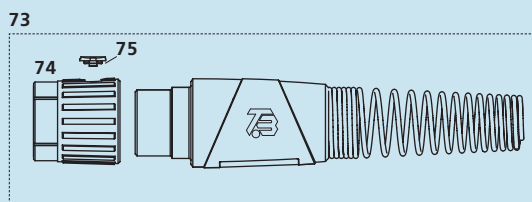
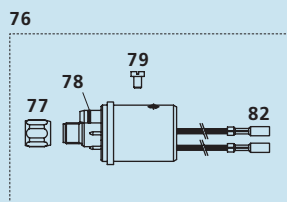
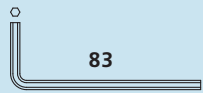
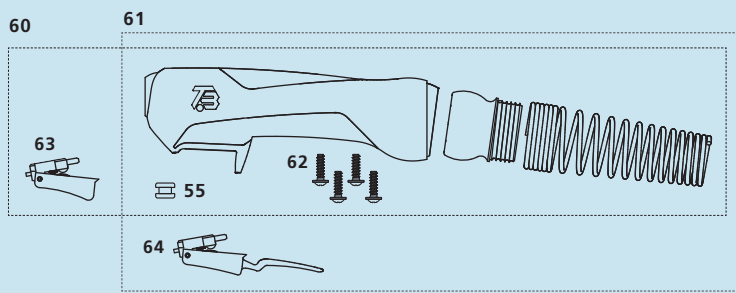

Nozzle support



Pos.	Description	Part no.
20	for contact tip M8	145P102008

Gas nozzle



Pos.	Description	Part no.
40	conical, NW 15 mm L= 68.5 mm	345P022045



41	conical, NW 11 mm L= 68.5 mm	345P023045
----	---------------------------------	------------



42	cylindrical, NW 20 mm L= 68.5 mm	345P021045
----	-------------------------------------	------------

Pos.	Description	Part no.
70	TBi-ProFlex XL coaxial cable XP 463	361PXL51_0**
70	TBi-ProFlex L coaxial cable XP 363	361POL51_0**
72	Hex nut M10x1	101P002005
73	Cable support Expert cpl., gas cooled	700P001064
74	Adaptor nut Expert (brass)	700P001010
75	Cap for adaptor nut Expert	700P002059
76	Central adaptor ESG cpl., 2 poles, moveable pins	701P001048
77	Sleeve nut M10x1	701P002005
78	O-Ring 4.0x1.0 mm (gas nipple)	365P100040
79	Screw M 4x6	100P008401

Pos.	Description	Part no.
80	Cable lug, flat	375P000023
81	Insulated connector, male, round	375P000004
82	Insulated connector, female, round	375P000003
83	Hex wrench size 2.5 mm	391P000036

** At the blank, please insert suitable information for torch length, e.g. 3 for 3 m

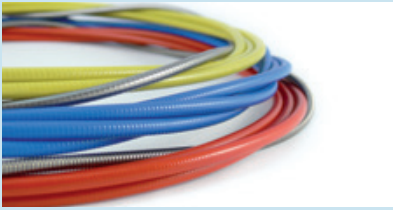

for steel wire

insulated liners

for wire

color

Part no.

0.8 - 1.0

blue

324P1545_4*

1.0 - 1.2

red

324P2045_4*

1.2 - 1.6

yellow

324P2545_4*

* At the blank, please insert suitable information for torch length, e.g. 3, 4 or 5 for 3 m, 4 m or 5 m long torches.



TBi ArcVisor^{Plus}

The TBi ArcVisorPlus Welding Helmet provides the technical characteristics of a premium product as well as an attractive design. The large viewing area and various possibilities of adjustment guarantee ergonomic working conditions for the professional welder.

- Filter quality classification 1/1/1/1
- Viewing area 98 x 55 mm

PU 12 TBi ArcVisor Plus, DIN 9 - 13

Part no. 714P101023



Welding glove MIG/MAG

Welding glove from dyed cow split leather, protection according to EN12477 Type A.

High comfort due to moisture absorbing inner lining and flexible thumb. Reinforced inner palm with double stitched seam. A length of 38 cm provides optimum protection for hand and wrist.

PU 12 Welding glove MIG/MAG

Part no. 714P102500



TBi Anti-spatter spray Classic

The TBi anti-spatter spray Classic effectively prevents adhesion of welding spatter on the nozzle and the work piece. Apply regularly to the torch head to increase the lifetime of consumables and facilitate cleaning of the torch.

PU 12 TBi anti-spatter spray Classic (400 ml)

Part no. 392P000074



TBi MIG-Tool 2

Indispensable tool to clean and remove the gas nozzle, loosen and tighten the contact tip or cut the welding wire.

PU 1 TBi MIG-Tool 2

Part no. 391P000012