

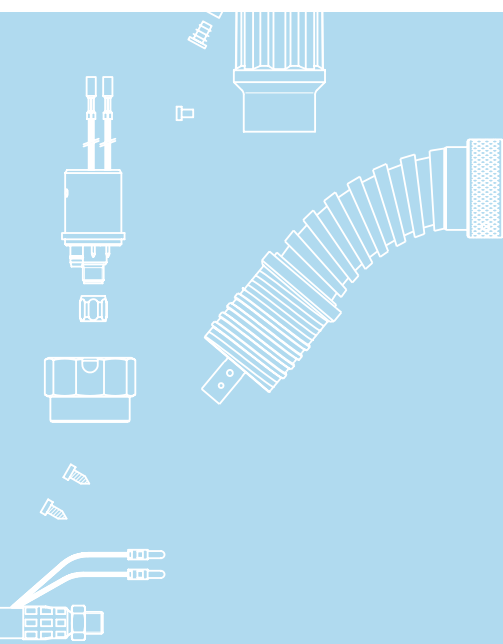

Classic TBI 150 E3



Air cooled

Uses same consumables as TBI 150

Slip-on fume shroud

Technical data

MIG/MAG semi-automatic fume extraction welding torch TBI 150 E3

Rating at 60% duty cycle
(10 min. cycle)

- Mixed gas: 150 A
- CO₂: 180 A

Cooling method air cooling

Wire diameter 0.6 - 1.0 mm

Gas flow 8 l/min

Technical specification according to IEC 60974-7

Weight with 1.5m cable 1.20 kg

Connection Euro-Central connector
other connectors are available
upon request.

Torch rating will be reduced when using pulsed-arc power sources.
Custom lengths of the cable assembly are available upon request.

Ordering Information

TBI 150 E3 ESG, 50° bent 202P3X13_0*

* At the blank, please insert 3, 4 or 5 for a torch length of 3, 4 or 5m.

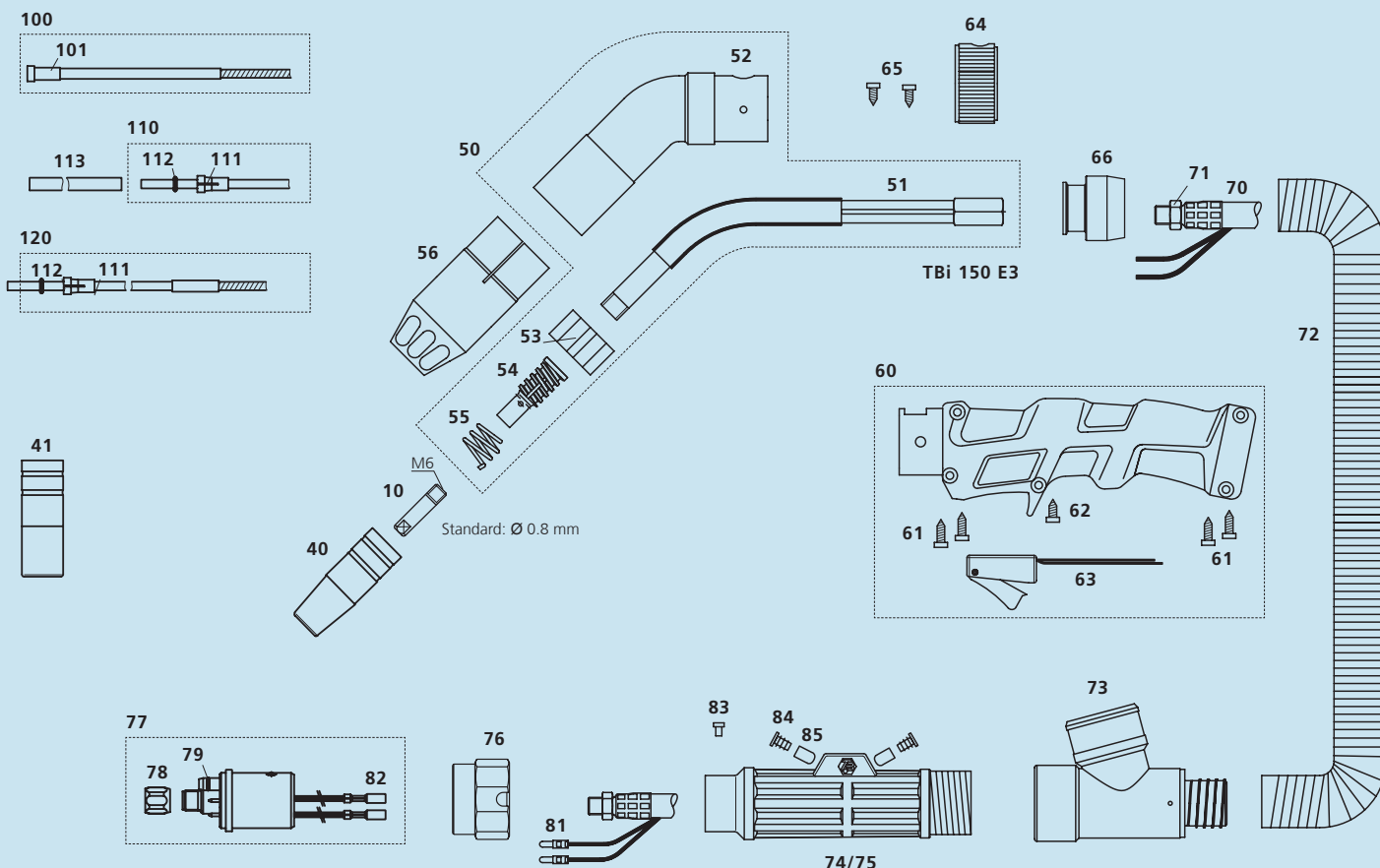

Pos. Description

Part. No.

Pos. Description

Part. No.

Contact tips

► 10	Contact tip M6x25, Ecu	340P_1073*
10	Contact tip M6x25, CuCrZr	340P_3073*
10	Contact tip M6x25 Alu, Ecu	341P_1073*

Gas nozzles

► 40	Nozzle conical diam. 12 mm	345P012002
40	Nozzle conical diam. 12 mm long insulation	345P012402
41	Nozzle cylindrical diam. 16 mm	345P011002
41	Nozzle cylindrical diam. 16 mm long insulation	345P011402

Spare parts

50	Torch neck TBi 150 E3, cpl.	202P001023
51	Inner tube TBi 150 E3	202P001022
52	Outer tube TBi 150 E3	202P001020
53	Insulator TBi 150 E3	202P002007
54	Nozzle support TBi 150 w/o spring	102P002037
55	Nozzle spring TBi 140/145/150	102P002011
56	Fume shroud TBi 150 E3	202P002010
60	Handle cpl., blue, housed micro switch, TBi E2/E3	380P220606
61	Self-cutting screw 3.5x14.0 mm	100P797101
62	Self-cutting screw, short, TBi E3	100P008411
63	Micro switch, housed, cpl.	600P101046
64	Air regulator small	200P102003
65	Screw for air regulator	100P797103
66	Handle fitting for 29 mm fume hose	252P102026
70	Coaxial cable cpl., 16 sqmm	359P1611_0*
71	Hex nut M10x1	101P002005
72	Fume extraction hose D=29 mm	306P293600

Wire guides

100	Liner w/ insulation white (x.40 m) for wire 0.6-0.9	324P1338_4*
► 100	Liner w/ insulation blue (x.40 m) for wire 0.8-1.0	324P1545_4*
101	Collet for liner 1.3x3.8 mm	330P015040
101	Collet for liners diam. 4.5 mm	330P025045
110	PTFE-liner blue (x.50 m) for wire 0.6-0.9	326P1540_5*
111	Collet for liners 4.0 mm	331P020040
112	O-ring 3.50x1.50 mm (for liner)	365P150035
113	Support tube 5x4.4 mm, L=150 mm	329P544150
120	PA-Alu wire guide (x.50 m) for wire 0.8-1.0	328P2040_A*

► = Standard equipment

* At the blank, please insert suitable information for torch length or wire diameter, e.g. 08 for 0.8 mm or 3 for 3 m.

© 2016 TBi Industries GmbH. All rights reserved. Subject to change without notice. Warranty only when using original TBi consumables and spare parts. Excerpts and reprints not permitted. Nr. DOKP113502, 06/2016.