

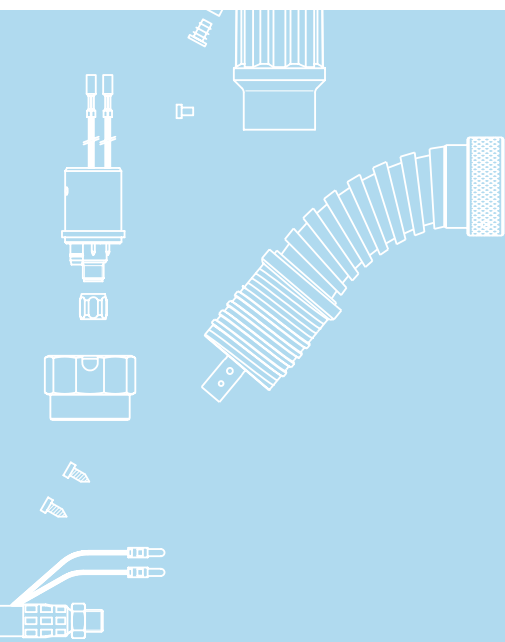

Classic TBI 250 E3



Air cooled

Same consumables as TBI 250

Slip-on fume shroud

Technical data

MIG/MAG semi-automatic fume extraction welding torch TBI 250 E3

Rating at 60% duty cycle
(10 min. cycle)

- Mixed gas: 200 A
- CO₂: 230 A

Cooling method air cooling

Wire diameter 0.8 - 1.2 mm

Gas flow 10 l/min

Technical specification according to IEC 60974-7

Weight with 1.5m cable 1.40 kg

Connection Euro-Central connector
other connectors are available
upon request.

Torch rating will be reduced when using pulsed-arc power sources.
Custom lengths of the cable assembly are available upon request.

Ordering Information

TBI 250 E3 ESG, 50° bent 204P3X13_0*

* At the blank, please insert 3, 4 or 5 for a torch length of 3, 4 or 5 m.

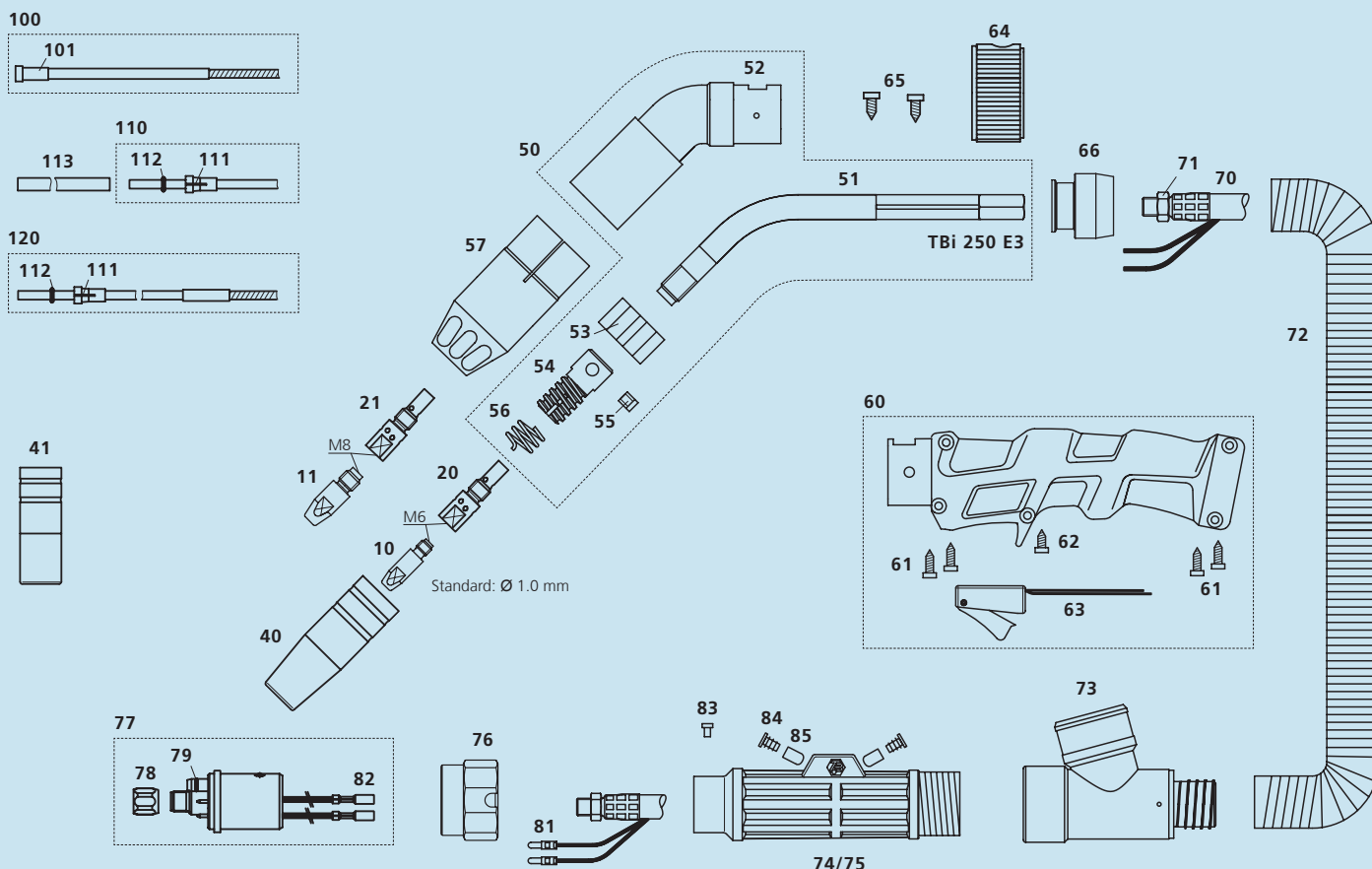

Pos. Description

Part. No.

Pos. Description

Part. No.

Contact tips

▶ 10	Contact tip M6x28, Ecu	340P_1069*
10	Contact tip M6x28, CuCrZr	340P_3069*
10	Contact tip M6x28 Alu, Ecu	341P_1069*
11	Contact tip M8x30, Ecu	340P_1262*
11	Contact tip M8x30, CuCrZr	340P_3262*
11	Contact tip M8x30 Alu, Ecu	341P_1262*

Tip holders

▶ 20	Tip holder M6 / L=35 mm	342P006003
21	Tip holder M8 / L=35 mm	342P008003

Gas nozzles

▶ 40	Nozzle conical diam. 15 mm	345P012003
40	Nozzle conical diam. 15 mm long insulation	345P012303
41	Nozzle cylindrical diam. 20 mm	345P011003
41	Nozzle cylindrical diam. 20 mm long insulation	345P011303

Spare parts

50	Torch neck TBi 250 E3, cpl.	204P001065
51	Inner tube TBi 250 E3	204P001063
52	Outer tube TBi 250 E3	204P001064
53	Insulator TBi 250 E3	204P002013
54	Nozzle support TBi 250 E3	103P002031
55	Cylindrical pin screw M3x4	100P008402
56	Nozzle spring TBi 250/252/351	103P002006
57	Fume shroud TBi 250 E3	204P002030
60	Handle cpl., blue, housed micro switch, TBi E2/E3	380P220606
61	Self-cutting screw 3.5x14.0 mm	100P797101
62	Self-cutting screw, short, TBi E3	100P008411
63	Micro switch, housed, cpl.	600P101046
64	Air regulator small	200P102003

▶ = Standard equipment

* At the blank, please insert suitable information for torch length or wire diameter, e.g. 08 for 0.8 mm or 3 for 3 mm.

© 2017 TBi Industries GmbH. All rights reserved. Subject to change without notice. Warranty only when using original TBi consumables and spare parts. Excerpts and reprints not permitted. Nr. DOKP113522, 10/2017.

TBi Industries GmbH
Ruhberg 14
D-35463 Fernwald-Steinbach
P.O. Box 67
D-35461 Fernwald-Steinbach

Tel. + 49 6404 9171-0
Fax. + 49 6404 9171-40
Internet: www.tbi-industries.com
E-mail: info@tbi-industries.com

65	Screw for air regulator	100P797103
66	Handle fitting for 29 mm fume hose	252P102026
70	Coaxial cable TBi ProFlex M	361P0M11_0*
71	Hex nut M10x1	101P002005
72	Fume extraction hose D=29 mm	306P293600
73	T-joint cpl. for 29 mm fume hose	200P101013
74	Cable support housing (only with pos. 75)	701P102070
75	Cable support cover (only with pos. 74)	701P102071
76	Adaptor nut	701P001013
77	Central adaptor ESG cpl., 2 poles, moveable pins	701P001048
78	Sleeve nut M10x1	701P002005
79	O-ring 4.0x1.0 mm (gas nipple)	365P100040
81	Insulated connector, male, round	375P000004
82	Insulated connector, female, round	375P000003
83	Slotted screw M4x6	100P008401
84	Square cap	200P102006
85	Cap for water connector	395P000004

Wire guides

100	Liner w/ insulation blue (x.40 m) for wire 0.8-1.0	324P1545_4*
▶ 100	Liner w/ insulation red (x.40 m) for wire 1.0-1.2	324P2045_4*
101	Collet for liners diam. 4.5 mm	330P025045
110	PTFE-liner blue (x.50 m) for wire 0.6-0.9	326P1540_5*
110	PTFE-liner red (x.50 m) for wire 1.0-1.2	326P2040_5*
111	Collet for liners 4.0 mm	331P020040
112	O-ring 3.50x1.50 mm (for liner)	365P150035
113	Support tube 5x4.4 mm, L=150 mm	329P544150
120	PA-Alu wire guide (x.50 m) for wire 0.8-1.0	328P2040_A*