

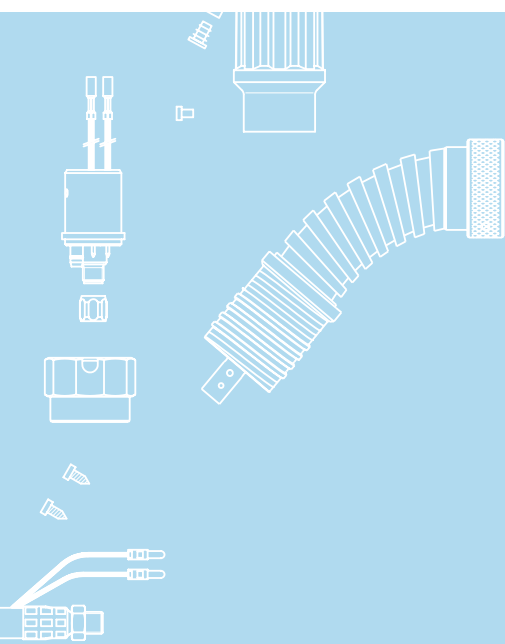

Classic TBI 511 E3



Water cooled

Same consumables as TBI 511

Slip-on fume shroud

Technical data

MIG/MAG semi-automatic fume extraction welding torch TBI 511 E3

Rating at 100% duty cycle
(10 min. cycle)

- Mixed gas: 380 A
- CO₂: 380 A

Cooling method water cooling

Wire diameter 1.0 - 1.6 mm

Gas flow 14 l/min

Technical specification according to IEC 60974-7

Weight with 1.5m cable 1.70 kg

Connection Euro-Central connector
other connectors are available
upon request.

Torch rating will be reduced when using pulsed-arc power sources.
Custom lengths of the cable assembly are available upon request.

Ordering Information

TBI 511 E3 ESW, 50° bent 234P4X15_0*

* At the blank, please insert 3, 4 or 5 for a torch length of 3, 4 or 5 m.

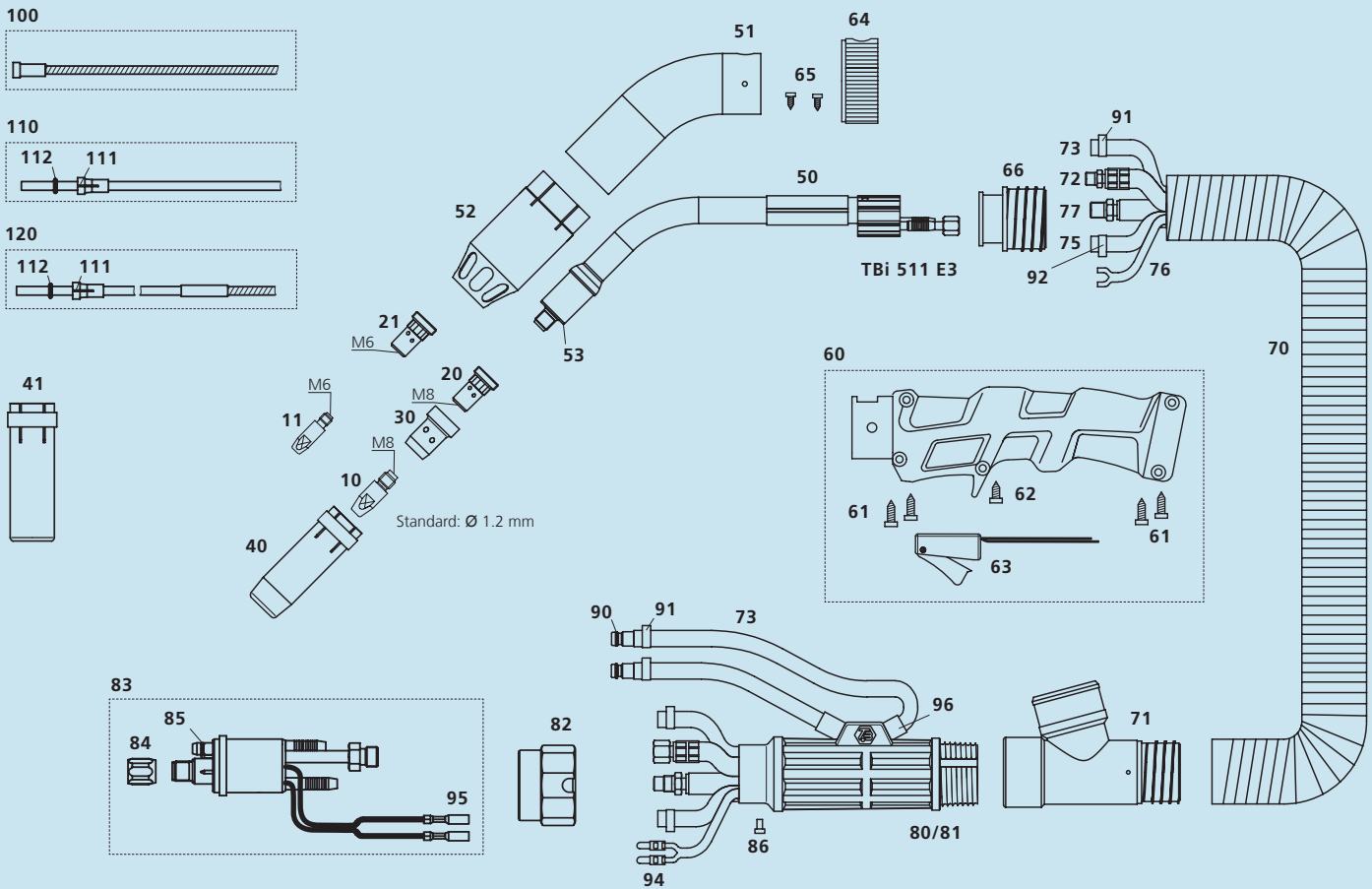

Pos. Description

Part. No.

Pos. Description

Part. No.

Contact tips

▶ 10	Contact tip M8x30, Ecu	340P_1262*
10	Contact tip M8x30, CuCrZr	340P_3262*
10	Contact tip M8x30 Alu, Ecu	341P_1262*
11	Contact tip M6x28, Ecu	340P_1069*
11	Contact tip M6x28, CuCrZr	340P_3069*
11	Contact tip M6x28 Alu, Ecu	341P_1069*

Tip holders

▶ 20	Tip holder M8 / L=25 mm	342P008033
20	Tip holder M8 / L=29 mm	342P008133
21	Tip holder M6 / L=25 mm	342P006033
21	Tip holder M6 / L=29 mm	342P006133

Gas diffusers

▶ 30	Gas diffuser, black	130P002026
30	Gas diffuser, white	130P002017
30	Gas diffuser, brown	130P002031

Gas nozzles

▶ 40	Nozzle conical diam. 16 mm	345P012030
41	Nozzle cylindrical diam. 20 mm	345P011030

Spare parts

50	Torch neck TBi 511 E3	234P001036
51	Outer tube TBi 360/511/7G/7W E3	234P102035
52	Fume shroud TBi 360/511/7G/7W/8W E3	200P002043
53	Insulating washer	130P002004
60	Handle cpl., blue, housed micro switch, TBi E2/E3	380P220606
61	Self-cutting screw 3.5x14.0 mm	100P797101
62	Self-cutting screw, short, TBi E3	100P008411

▶ = Standard equipment

* At the blank, please insert suitable information for torch length or wire diameter, e.g. 08 for 0.8 mm or 3 for 3 mm.

63	Micro switch, housed, cpl.	600P101046
64	Air regulator large	200P102001
65	Fillister head screw, 2.9x6.5 mm	100P797103
66	Handle fitting for 38 mm fume hose	274P102011
70	Fume extraction hose D=38 mm	306P384600
71	T-joint cpl. for 38 mm fume hose	200P101012
72	Water-power cable Classic, blue, 2-C	316P1621_0*
73	PVC hose, braided, black, 5x1.5 mm	302P020000
75	PVC-Gas hose, black, 4.5x1.5 mm	302P010000
76	Control cable x.10m, round, cpl., for TBi E1/E2/E3	301P2304_1*
77	Wire conduit yellow 'Classic'	356P0401_0*
80	Cable support housing (only with pos. 81)	701P102070
81	Cable support cover (only with pos. 80)	701P102071
82	Adaptor nut	701P001013
83	Central adaptor ESW cpl., 2 poles, moveable pins	701P001049
84	Sleeve nut M10x1	701P002005
85	O-ring 4.0x1.0 mm (gas nipple)	365P100040
86	Slotted screw M4x6	100P008401
90	Quick connector	701P002064
91	Hose clamp Ø 9.5 with ring	373P100095
92	Hose clamp Ø 8.7	371P000087
94	Insulated connector, male, round	375P000004
95	Insulated connector, female, round	375P000003
96	Rubber hose 10x2.0 mm	310P102102

Wire guides

▶ 100	Liner w/o insulation (x.40 m) for wire 1.0-1.2	322P2045_4*
100	Liner w/o insulation (x.40 m) for wire 1.4-1.6	322P2545_4*
110	PTFE-liner red (x.50 m) for wire 1.0-1.2	326P2040_5*
110	PTFE-liner yellow (x.50 m) for wire 1.2-1.6	326P2747_5*
111	Collet for liners 4.0 mm	331P020040
111	Collet for liners 4.7 mm	331P027047
112	O-ring 3.50x1.50 mm (for liner)	365P150035
120	PA-Alu wire guide (x.50 m) for wire 0.8-1.0	328P2040_A*
120	PA-Alu wire guide (x.50 m) for wire 1.2-1.6	328P2347_A*

© 2019 TBI Industries GmbH. All rights reserved. Subject to change without notice. Warranty only when using original TBI consumables and spare parts. Excerpts and reprints not permitted. Nr. DOKP113552, 09/2019.

TBI Industries GmbH
Ruhberg 14
D-35463 Fernwald-Steinbach
P.O. Box 67
D-35461 Fernwald-Steinbach

Tel. + 49 6404 9171-0
Fax. + 49 6404 9171-40
Internet: www.tbi-industries.com
E-mail: info@tbi-industries.com