



## Top 2000 TBi 8W E3

Water cooled

Same consumables as TBi 8G / TBi 8W

Slip-on fume shroud

### Technical data

#### MIG/MAG semi-automatic fume extraction welding torch TBi 8W E3

Rating at 100% duty cycle

(10 min. cycle)

- Mixed gas: 500 A

- CO<sub>2</sub>: 550 A

Cooling method water cooling

Wire diameter 1.2 - 3.2 mm

Gas flow 28 l/min

Technical specification according to IEC 60974-7

Weight with 1.5m Kabel 1.80 kg

Connection Euro-Central connector  
other connectors are available  
upon request.

Torch rating will be reduced when using pulsed-arc power sources.  
Custom lengths of the cable assembly are available upon request.

### Ordering information

TBi 8W E3 RWZ, 40° bent 272P4X25\_0\*

\* At the blank, please insert 3,4 or 5 for a torch length of 3, 4 or 5 m.

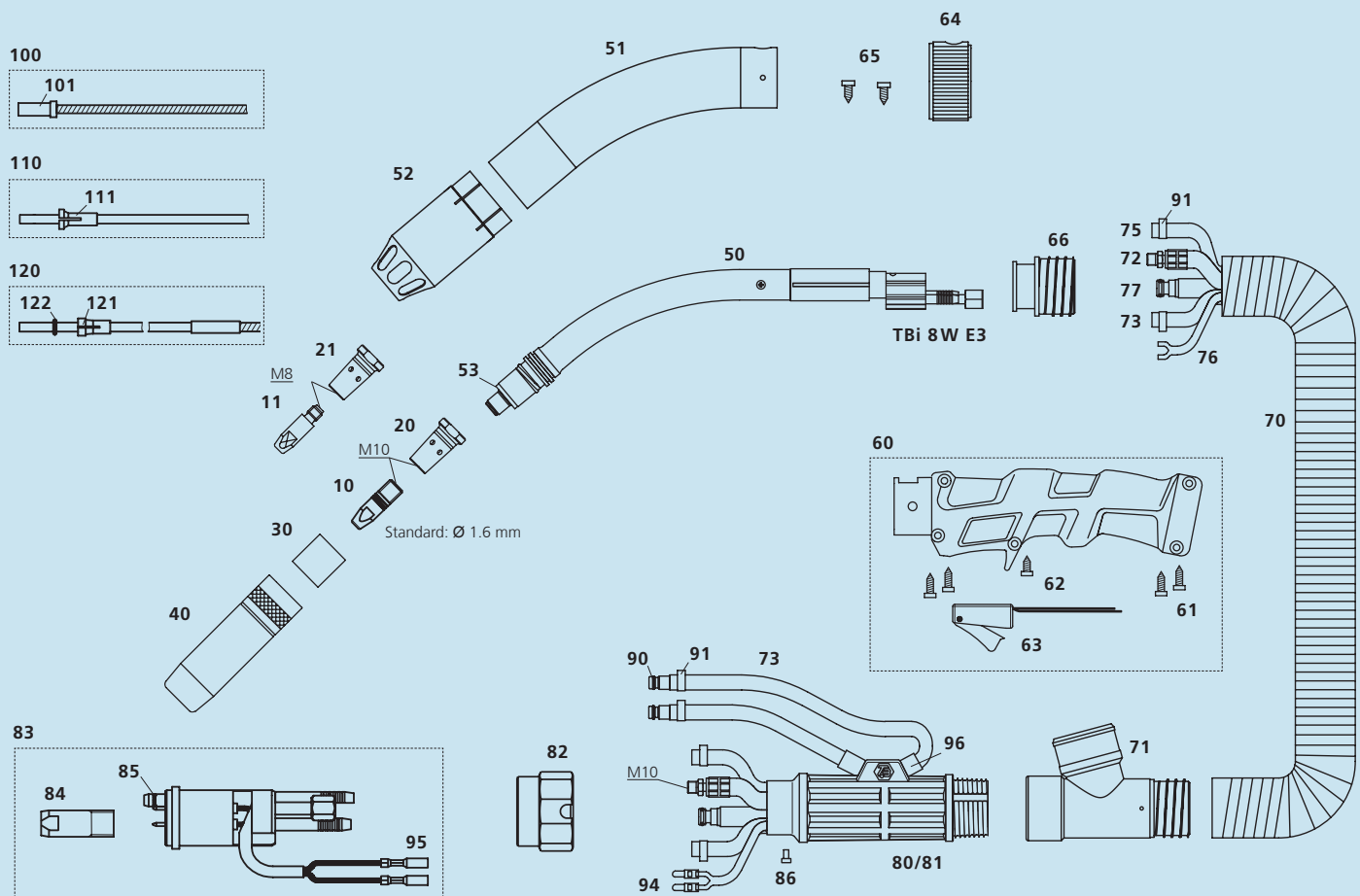

Pos.	Description	Part. No.	Pos.	Description	Part. No.
<b>Contact tips</b>					
▶ 10	Contact tip M10x33, ECu	340P_1402*	72	Water-power cable, blue, 2-C (TBi 8W E3)	316P16WW_0*
10	Contact tip M10x33, CuCrZr	343P_3402*	73	Water hose 2-C, black, 5x1.5 mm	303P070000
11	Contact tip M8x30, ECu	340P_1262*	75	PVC hose, braided, black, 5x1.5 mm	302P020000
11	Contact tip M8x30, CuCrZr	340P_3262*	76	Control cable x.10m, round, cpl., for Tbi E1/E2/E3	301P2304_1*
11	Contact tip M8x30 Alu, ECu	341P_1262*	77	Wire conduit, black (8W, 10W)	354P0C0C_0*
<b>Tip holders</b>					
▶ 20	Tip holder M10 / L=29 mm	342P010072	80	Cable support housing (only with pos. 81)	701P102070
21	Tip holder M8 / L=30 mm	342P008072	81	Cable support cover (only with pos. 80)	701P102071
<b>Nozzle insulators</b>					
▶ 30	Nozzle insulator glasfiber	346P054860	82	Adaptor nut	701P001013
<b>Gas nozzles</b>					
▶ 40	Nozzle conical diam. 16 mm L=80.5mm	345P922171	83	Central adaptor RWZ cpl. (8W, 10W), moveable pins	701P001001
<b>Spare parts</b>					
50	Torch neck Tbi 8W E3	272P101050	84	Centering bolt M14x1 RGZ / RWZ	701P002083
51	Outer tube Tbi 8W E3	272P102053	85	O-ring 4.0x1.0 mm (gas nipple)	365P100040
52	Fume shroud Tbi 360/511/7G/7W/8W E3	200P002043	86	Slotted screw M4x6	100P008401
53	Insulating washer	130P002003	90	Quick connector	701P002064
60	Handle cpl., blue, housed micro switch, Tbi E2/E3	380P220606	91	Hose clamp Ø 9.5 with ring	373P100095
61	Self-cutting screw 3.5x14.0 mm	100P797101	94	Insulated connector, male, round	375P000004
62	Self-cutting screw, short, Tbi E3	100P008411	95	Insulated connector, female, round	375P000003
63	Micro switch, housed, cpl.	600P101046	96	Rubber hose 10x2.0 mm	310P102102
64	Air regulator large	200P102001	<b>Wire guides</b>		
65	Fillister head screw, 2.9x6.5 mm	100P797103	100	Liner w/o insulation (x.40 m) for wire 1.6-2.0	322P2863_4*
66	Handle fitting for 38 mm fume hose	274P102011	▶ 100	Liner w/o insulation (x.40 m) for wire 2.0-2.4	322P3570_4*
70	Fume extraction hose D=38 mm	306P384600	100	Liner w/o insulation (x.40 m) for wire 2.8-3.2	322P4570_4*
71	T-joint cpl. for 38 mm fume hose	200P101012	101	Collet for liner 2.8x6.3	330P028063
			101	Collet for liner 3.5x7.0	330P035070
			101	Collet for liner 4.5x7.0	330P045070
			110	PTFE-liner white (x.50 m) for wire 1.6-2.8	326P4060_5*
			111	Collet for liners 4.0x6.0	331P040060
			120	PA-Alu wire guide (x.50 m) for wire 1.2-1.6	328P2347_A*
			120	PA-Alu wire guide (x.50 m) for wire 1.6	328P2947_A*
			121	Collet for liners 4.7 mm	331P027047
			122	O-ring 3.50x1.50 mm (for liner)	365P150035

▶ = Standard equipment

\* At the blank, please insert suitable information for torch length or wire diameter, e.g. 08 for 0.8 mm or 3 for 3 m.

© 2016 Tbi Industries GmbH. All rights reserved. Subject to change without notice. Warranty only when using original Tbi consumables and spare parts. Excerpts and reprints not permitted. Nr. DOKP113442, 06/2016.

Tbi Industries GmbH  
Ruhberg 14  
D-35463 Fernwald-Steinbach  
P.O. Box 67  
D-35461 Fernwald-Steinbach

Tel. + 49 6404 9171-0  
Fax. + 49 6404 9171-40  
Internet: www.tbi-industries.com  
E-mail: info@tbi-industries.com