

Ersatzteillisten
Spare parts lists

MIG/MAG Basic Line



INHALT / CONTENTS

Gasgekühlt / Gascooled	4 ... 7
TBi Basic 150 Mini	4
TBi Basic 240	5
TBi Basic 250	6
TBi Basic 360	7
Wassergekühlt / Watercooled	8 ... 9
TBi Basic 411	8
TBi Basic 511	9

TBi Basic 150 Mini

gasgekühlt / gas cooled
 M21: 150 A (35 %)
 CO₂: 180 A (35 %)
 0.6 – 1.0 mm

TBi Basic 150 Mini
 Anschlussmutter Messing / adaptor nut brass

3 m	102P3U1030
4 m	102P3U1040
5 m	102P3U1050

Stromdüse / Contact tip
 M6x25, Ecu



- 340P061073 Ø 0.6
- ▶ 340P081073 Ø 0.8
- 340P091073 Ø 0.9
- 340P101073 Ø 1.0

- Aluminium
- 341P081073 Ø 0.8
- 341P101073 Ø 1.0

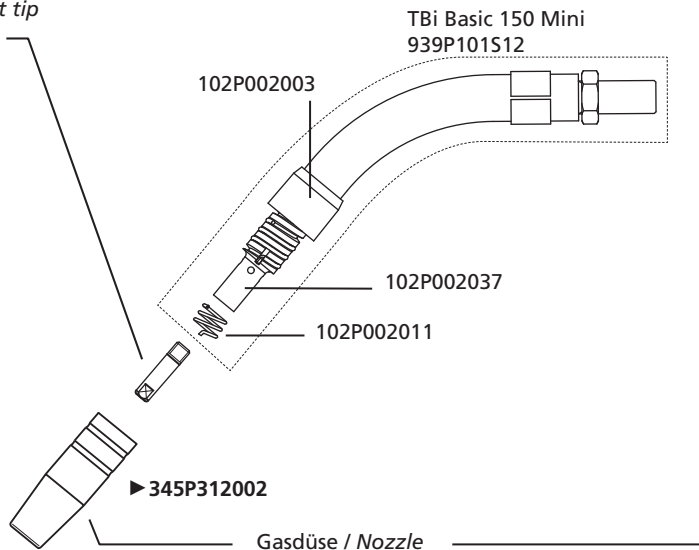

Gasdüse / Nozzle

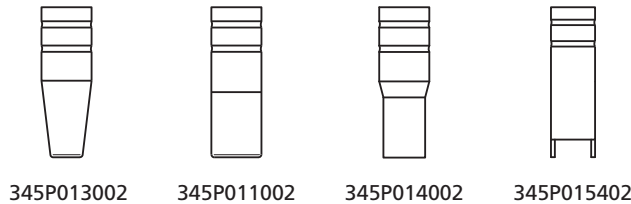

ESG kpl. / ESG cpl.
 701P001048

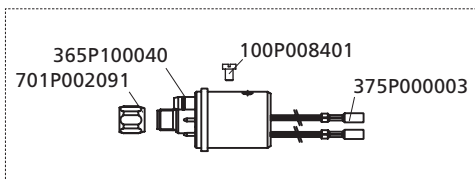

Knickschutz kpl. /
 Cable support cpl.
 700P001087

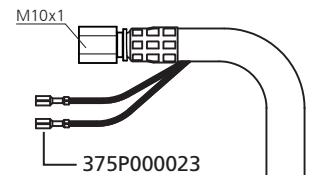
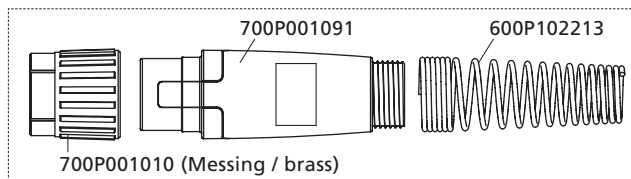

Koaxkabel TBi ProFlex S /
 Coaxial cable TBi ProFlex S

3 m:	361P0SN130
4 m:	361P0SN140
5 m:	361P0SN150

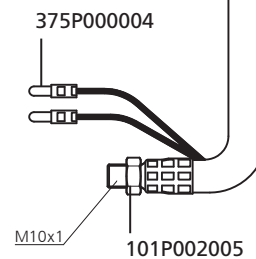

Griffschale kpl. / Handle cpl. kit
 380P000001

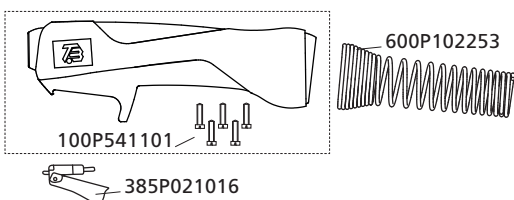

Drahtführungen / Wire guides

m Ø 0.6 - 0.9 Ø 0.8 - 1.0

Drahtführungsspirale für Stahldraht
 Liner for steel wire



	weiß / white	blau / blue
3	324P133834	▶ 324P154534
4	324P133844	▶ 324P154544
5	324P133854	▶ 324P154554

PTFE-Seele für Alu- und Edelstahldraht
 PTFE liner for alu- and stainless steel wire

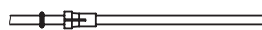

		blau / blue
3	-	326P154035
4	-	326P154045
5	-	326P154055

▶ Standard / Standard

TBi Basic 240

gasgekühlt / gas cooled
 M21: 220 A (35 %)
 CO₂: 250 A (35 %)
 0.8 – 1.2 mm

TBi Basic 240
 Anschlussmutter Messing / adaptor nut brass

3 m	112P3U1030
4 m	112P3U1040
5 m	112P3U1050

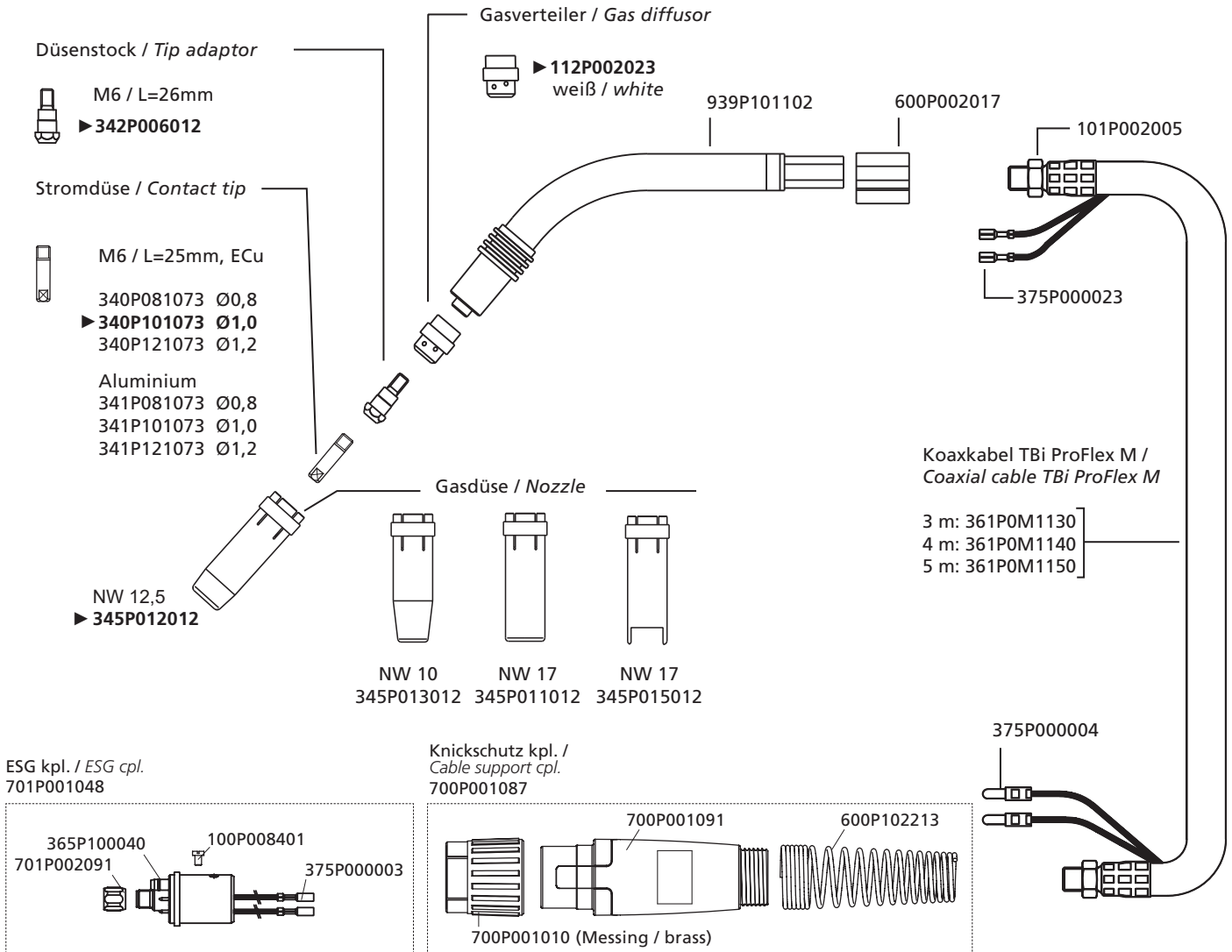

Drahtführungen / Wire guides	m	Ø 0.8 - 1.0	Ø 1.0 - 1.2
Drahtführungsspirale für Stahldraht Liner for steel wire	3	blau / blue	rot / red
	4	324P154534	▶ 324P204534
	5	324P154544	▶ 324P204544
PTFE-Seele für Alu- und Edelstahldraht PTFE liner for alu- and stainless steel wire	3	blau / blue	rot / red
	4	326P154035	326P204035
	5	326P154045	326P204045
PA-Seele mit Bronzespirale für Aludraht PA liner with bronze liner for alu wire	3	anthrazit / anthracite	—
	4	328P20403A	—
	5	328P20404A	—

▶ Standard / Standard

TBi Basic 250

gasgekühlt / gas cooled
 M21: 200 A (35 %)
 CO₂: 230 A (35 %)
 0.8 - 1.2 mm

TBi Basic 250
 Anschlussmutter Messing / adaptor nut brass

3 m	104P3U1030
4 m	104P3U1040
5 m	104P3U1050

Düsenstock / Tip adaptor

M6 / L=35mm



▶ 342P006003

M8 / L=35mm



342P008003

Stromdüse / Contact tip

M6x28, ECu



340P081069 Ø0.8
 340P091069 Ø0.9
 ▶ 340P101069 Ø1.0
 340P121069 Ø1.2

Aluminium

341P081069 Ø0.8
 341P101069 Ø1.0
 341P121069 Ø1.2

M8x30, ECu



340P081262
 -
 340P101262
 340P121262

Aluminium

341P081262
 341P101262
 341P121262

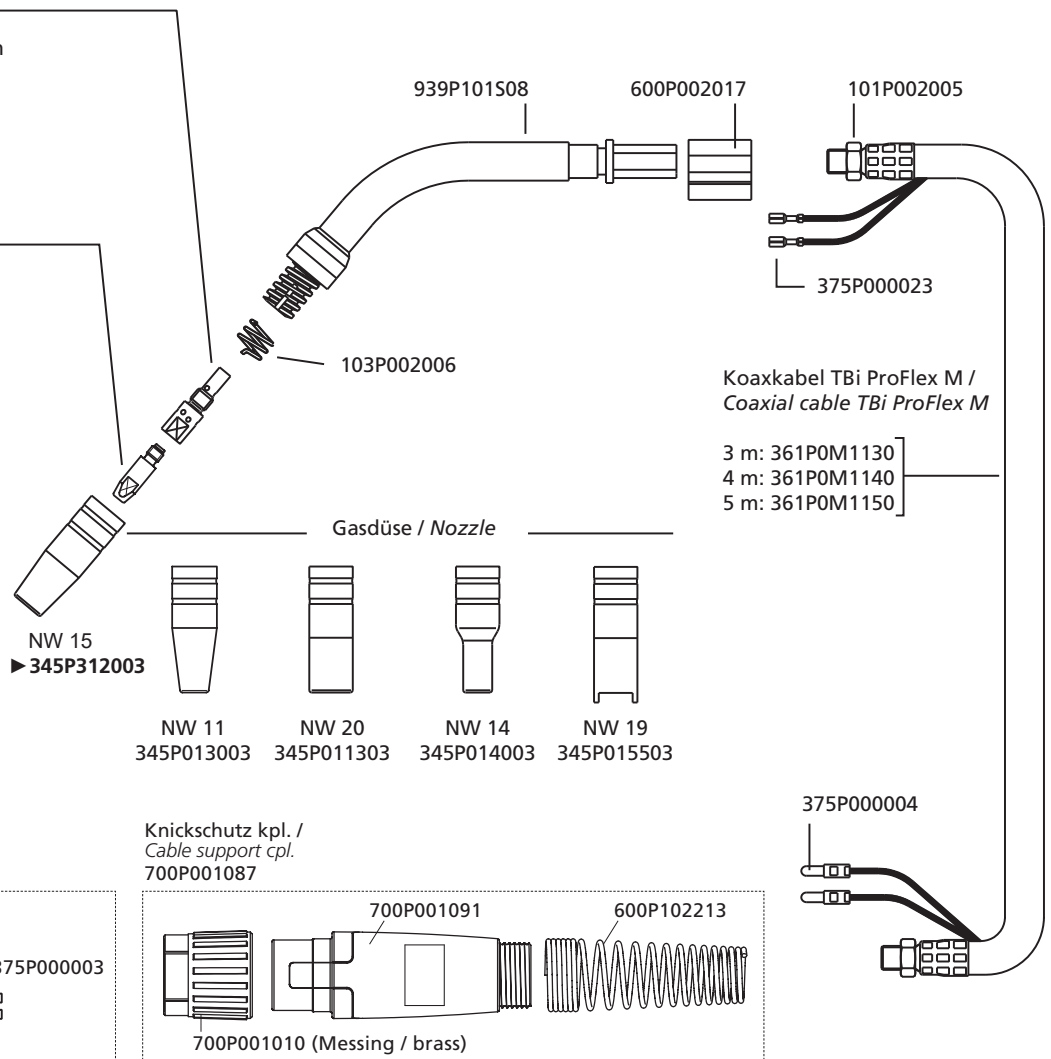

ESG kpl. / ESG cpl.
 701P001048

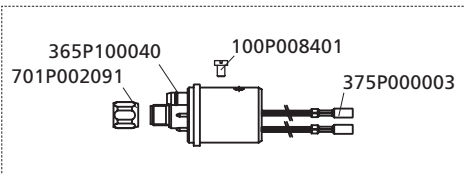

Knickschutz kpl. / Cable support cpl.
 700P001087

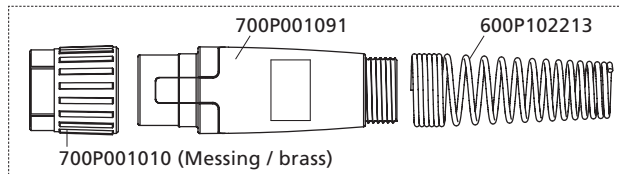

380P200400

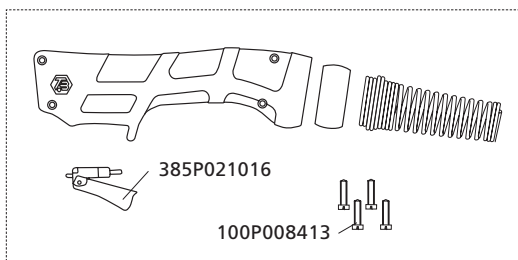

Drahtführungen / Wire guides

	m	Ø 0.8 - 1.0	Ø 1.0 - 1.2
Drahtführungsspirale für Stahldraht Liner for steel wire		blau / blue	rot / red
	3	324P154534	▶ 324P204534
	4	324P154544	▶ 324P204544
	5	324P154554	▶ 324P204554
PTFE-Seele für Alu- und Edelstahldraht PTFE liner for alu- and stainless steel wire		blau / blue	rot / red
	3	326P154035	326P204035
	4	326P154045	326P204045
	5	326P154055	326P204055
PA-Seele mit Bronzespirale für Aludraht PA liner with bronze liner for alu wire		anthrazit / anthracite	
	3	328P20403A	—
	4	328P20404A	—
	5	328P20405A	—

▶ Standard / Standard

TBi Basic 360

gasgekühlt / gas cooled
 M21: 300 A (35 %)
 CO₂: 330 A (35 %)
 1.0 – 1.6 mm

TBi Basic 360
 Anschlussmutter Messing / adaptor nut brass

3 m	114P3U1030
4 m	114P3U1040
5 m	114P3U1050

Gasverteiler / Gas diffusor



► **114P102004**
 weiß / white

Düsenstock / Tip adaptor



► **342P006014**



342P008014

Stromdüse / Contact tip



340P101069 Ø1,0
 ► **340P121069** Ø1,2



340P101262
340P121262

Aluminium

341P101069 Ø1,0
341P121069 Ø1,2

Aluminium

341P101262
341P121262

NW 16

► **345P312010**

Gasdüse / Nozzle



NW 12
345P013010

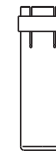

NW 20
345P011010



NW 20
345P015010

939P101104

600P002017

101P002005

375P000023

Koaxkabel TBi ProFlex L /
 Coaxial cable TBi ProFlex L

3 m: 361P0L1130
 4 m: 361P0L1140
 5 m: 361P0L1150

375P000004

ESG kpl. / ESG cpl.
 701P001048

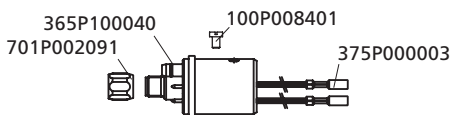

Knickschutz kpl. /
 Cable support cpl.
 700P001087

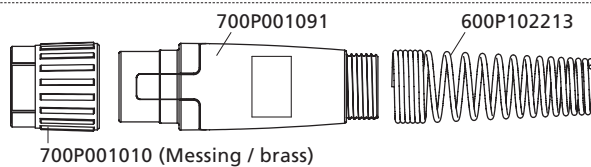

380P200400

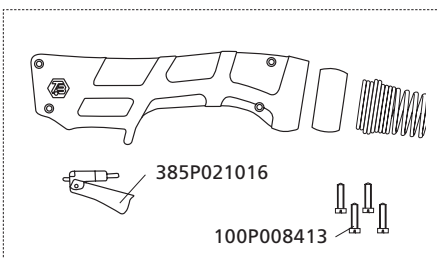

Drahtführungen / Wire guides

Drahtführungsspirale für Stahldraht
 Liner for steel wire

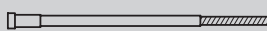

PTFE-Seele für Alu- und Edelstahldraht
 PTFE liner for alu- and stainless steel wire



PA-Seele m. Bronzespirale für Aludraht
 PA liner with bronze liner for alu wire



m	Ø 0.8 - 1.0	Ø 1.0 - 1.2	Ø 1.2 - 1.6
3	—	rot / red ► 324P204534	gelb / yellow 324P254534
4	—	► 324P204544	324P254544
5	—	► 324P204554	324P254554
3	—	rot / red 326P204035	gelb / yellow 326P274735
4	—	326P204045	326P274745
5	—	326P204055	326P274755
3	anthrazit / anthracite 328P20403A	—	anthrazit / anthracite 328P23473A
4	328P20404A	—	328P23474A
5	328P20405A	—	328P23475A

► **Standard / Standard**

TBi Basic 411

wassergekühlt / water cooled
 M21: 330 A (100 %)
 CO₂: 360 A (100 %)
 1.0 – 1.6 mm

TBi Basic 411
 Anschlussmutter Messing / brass adaptor nut

3 m	133P4U1030
4 m	133P4U1040
5 m	133P4U1050

Gasverteiler / Gas diffusor



► **130P102001**
 weiß / white

Stromdüse / Contact tip

M8x30, ECu	M6x28, ECu
340P081262 Ø0.8	340P081069
► 340P101262 Ø1.0	340P101069
340P121262 Ø1.2	340P121069
340P161262 Ø1.6	340P161069
Aluminium	Aluminium
341P101262 Ø1.0	341P101069
341P121262 Ø1.2	341P121069
341P161262 Ø1.6	341P161069

Düsenstock / Tip holders

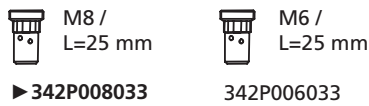

► **342P008033**

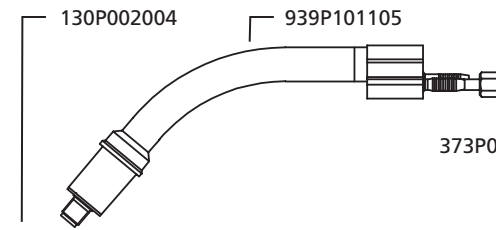

373P100095
 Stromwasserkabel
 Power cable
 3 m: 319P162130
 4 m: 319P162140
 5 m: 319P162150

373P000087
 Drahtförderschlauch
 Wire conduit
 3 m: 356P040130
 4 m: 356P040140
 5 m: 356P040150

375P000023

Gasdüse / Nozzle

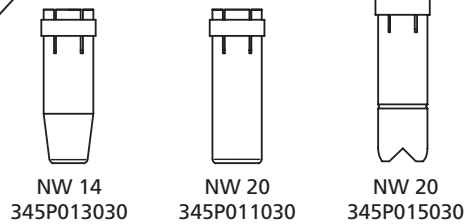

NW 16
 ► **345P312030**

ESW kpl. / ESW cpl.
 701P001049

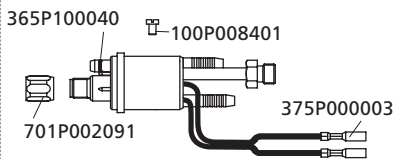

Knickschutz kpl. /
 Cable support cpl.
 700P001099

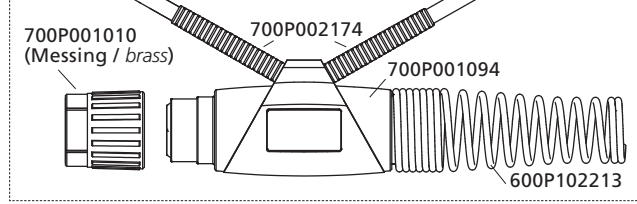

600P102201

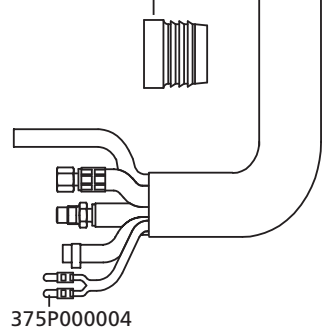

375P000004

380P200401

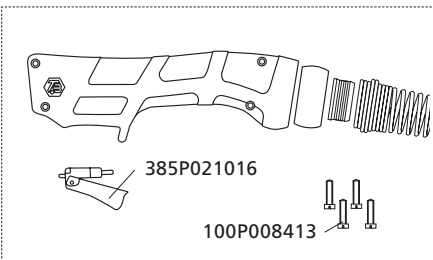

Drahtführungen / Wire guides

	m	Ø 0.8 - 1.0	Ø 1.0 - 1.2	Ø 1.2 - 1.6
Drahtführungsspirale für Stahldraht Liner for steel wire			blank / not insul.	blank / not insul.
	3	—	► 322P204534	322P254534
	4	—	► 322P204544	322P254544
	5	—	► 322P204554	322P254554
PTFE-Seele für Alu- und Edelstahldraht PTFE liner for alu- and stainless steel wire			rot / red	gelb / yellow
	3	—	326P204035	326P274735
	4	—	326P204045	326P274745
	5	—	326P204055	326P274755
PA-Seele mit Bronzespirale für Aludraht PA liner with bronze liner for alu wire		anthrazit / anthracite		anthrazit / anthracite
	3	328P20403A	—	328P23473A
	4	328P20404A	—	328P23474A
	5	328P20405A	—	328P23475A

► **Standard / Standard**

TBi Basic 511

wassergekühlt / water cooled
 M21: 350 A (100 %)
 CO₂: 380 A (100 %)
 1.0 – 1.6 mm

TBi Basic 511
 Anschlussmutter Messing / adaptor nut brass

3 m	134P4U1030
4 m	134P4U1040
5 m	134P4U1050

Gasverteiler / Gas diffuser



► **130P102001**
 weiß / white

Stromdüse / Contact tip

M8x30, Ecu	M6x28, Ecu
340P081262 Ø0.8	340P081069
340P101262 Ø1.0	340P101069
► 340P121262 Ø1.2	340P121069
340P161262 Ø1.6	340P161069
Aluminium	Aluminium
341P101262 Ø1.0	341P101069
341P121262 Ø1.2	341P121069
341P161262 Ø1.6	341P161069

Düsenstock / Tip holders

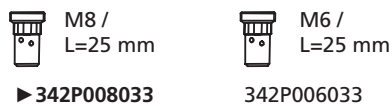

► **342P008033**

130P002004

939P101106

373P100095

Stromwasserkabel
 Power cable
 3 m: 319P162130
 4 m: 319P162140
 5 m: 319P162150

373P000087

Drahtförderschlauch
 Wire conduit
 3 m: 356P040130
 4 m: 356P040140
 5 m: 356P040150

375P000023

Gasdüse / Nozzle

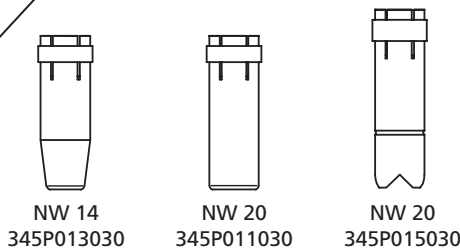

NW 14
 345P013030

NW 20
 345P011030

NW 20
 345P015030

NW 16
 ► **345P312030**

ESW kpl. / ESW cpl.
 701P001049

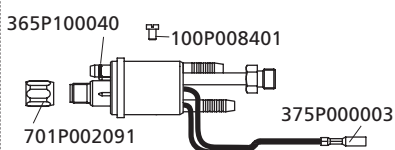

Knickschutz kpl. /
 Cable support cpl.
 700P001099

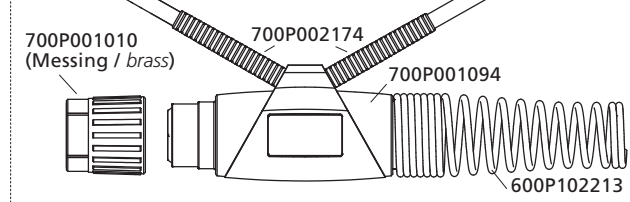

380P200401

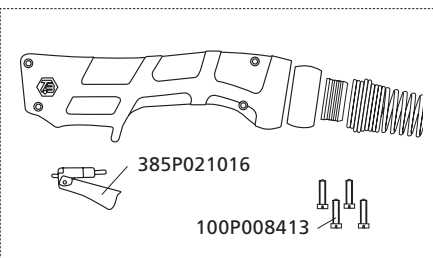

Drahtführungen / Wire guides

	m	Ø 0.8 - 1.0	Ø 1.0 - 1.2	Ø 1.2 - 1.6
Drahtführungsspirale für Stahldraht Liner for steel wire	3	—	blank / not insul.	blank / not insul.
	4	—	► 322P204534	322P254534
	5	—	► 322P204544	322P254544
PTFE-Seele für Alu- und Edelstahldraht PTFE liner for alu- and stainless steel wire	3	—	rot / red	gelb / yellow
	4	—	326P204035	326P274735
	5	—	326P204045	326P274745
PA-Seele mit Bronzespirale für Aludraht PA liner with bronze liner for alu wire	3	anthrazit / anthracite	—	anthrazit / anthracite
	4	328P20403A	—	328P23473A
	5	328P20404A	—	328P23474A

► Standard / Standard

Ready for Tomorrow.

© 2021 Tbi Industries GmbH. Alle Rechte vorbehalten. Technische Änderungen vorbehalten. Kopie oder Nachdruck auch auszugsweise nicht gestattet. / All rights reserved. Subject to change without notice. Excerpts and reprints not permitted. DOKP5S200A, 06/2021.

Tbi Industries GmbH
Ruhberg 14
35463 Fernwald-Steinbach
Germany

Tel. +49 6404 9171-0
Fax. +49 6404 9171-58
www.tbi-industries.com
info@tbi-industries.com